

THE CITY OF LOS ANGELES OR ITS OFFICERS OR AGENTS SHALL NOT BE RESPONSIBLE FOR THE ACCURACY OR COMPLETENESS OF ELECTRONIC COPIES OF THIS PLAN SHEET.

PLANS PREPARED BY:  
(DESIGN STAGE ONLY)

Sheet Version 3.0

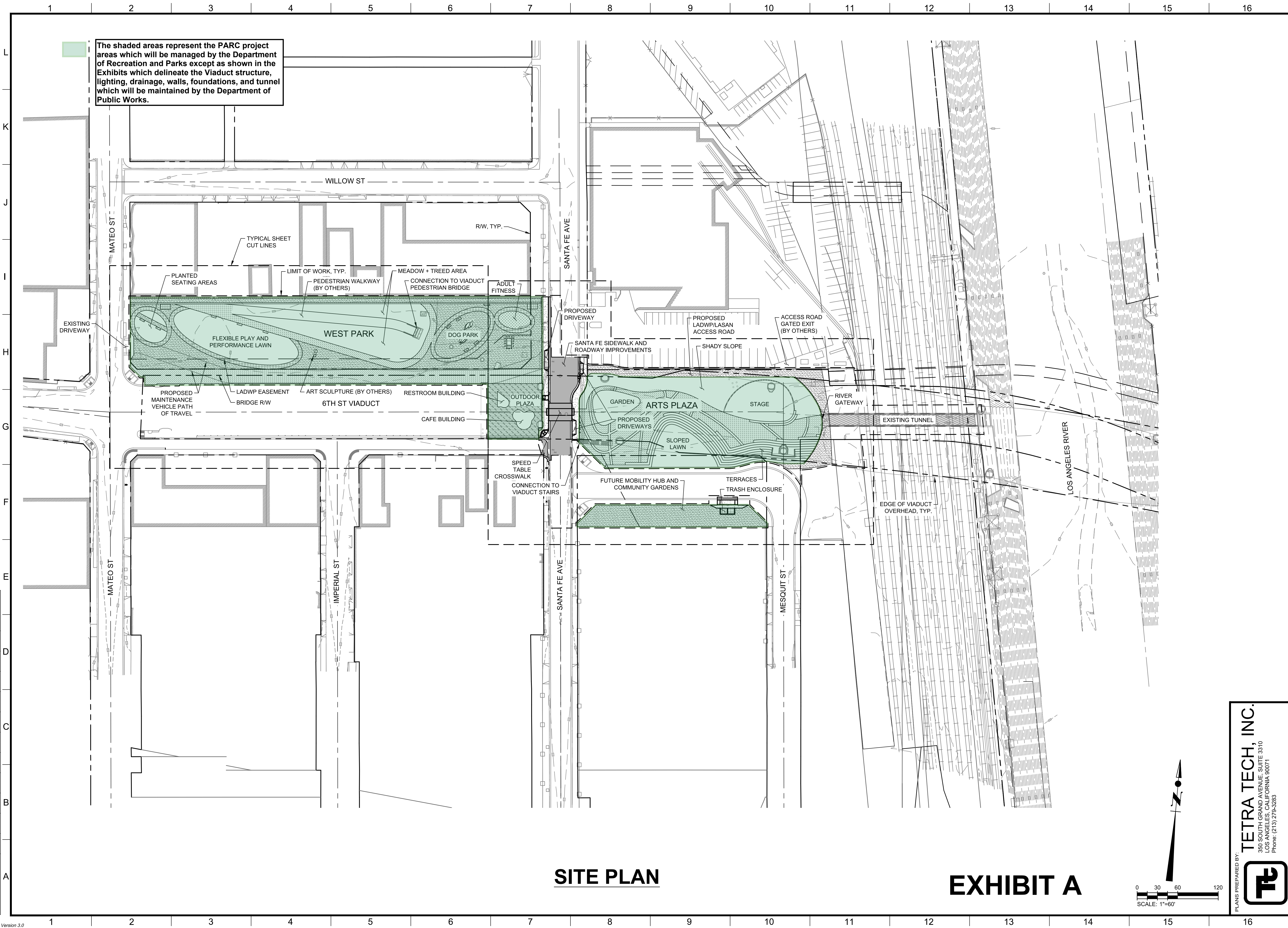

SITE PLAN

EXHIBIT A

TETRA TECH, INC.  
350 SOUTH GRAND AVENUE, SUITE 3310  
LOS ANGELES, CALIFORNIA 90071  
Phone: (213) 279-5263

ENGINEERING  
CITY OF LOS ANGELES

DATE: BY:  
NO. REVISIONS:  
INDEX NO.  
BUILDING NO.

DEPARTMENT OF PUBLIC WORKS  
GARY LEE MOORE, P.E., ENV SP

ENGINEER: JASON L. FUSSELL  
DESIGNED BY: JUSTIN SMITH  
DRAWN BY: JUSTIN SMITH  
CHECKED BY: MAURICIO ARGENTE  
APPROVED BY: JASON L. FUSSELL  
TT.DWG - SMITH, JUSTIN

CITY OF LOS ANGELES  
VERT. CONTROL: LA CITY BM 12-04070, 11-02339, NGVD29, 1985 ADJ  
HORIZ. CONTROL: NAD83 (ZONE 9) COORDINATES

SHEET TITLE:  
OVERALL SITE PLAN

PROJECT:  
SIXTH STREET PARK, ARTS AND RIVER  
CONNECTIVITY IMPROVEMENTS (PARC)

ADDRESS:  
SIXTH STREET OVER THE  
LOS ANGELES RIVER

WORK ORDER NO.  
E700235D

FILE NO.  
1

DRAWING NO.  
G-013

SHEET 13 OF 231 SHEETS

7/30/2019 8:46:24 AM - C:\PROJECTS\IRVINE\2004\3\200-20043-17001\CAD\SHEETFILES\G-013\_OVERALL SITE PLAN - TT.DWG - SMITH, JUSTIN

90% DESIGN SUBMITTAL - 07/25/2019



